

Adeje – Roque del Conde

# Corner plot with project and license in Roque del Conde

Property ID: ES243184889



[www.von-poll.com](http://www.von-poll.com)

PURCHASE PRICE: 850.000 EUR • LAND AREA: 700 m<sup>2</sup>

Property ID: ES243184889 - 38660 Adeje – Roque del Conde

- At a glance
- The property
- A first impression
- Details of amenities
- All about the location
- Other information
- Contact partner

Property ID: ES243184889 - 38660 Adeje – Roque del Conde

## At a glance

Property ID	ES243184889	Purchase Price	850.000 EUR
-------------	-------------	----------------	-------------

Property ID: ES243184889 - 38660 Adeje – Roque del Conde

## The property



Property ID: ES243184889 - 38660 Adeje – Roque del Conde

## The property





Property ID: ES243184889 - 38660 Adeje – Roque del Conde

## The property



Property ID: ES243184889 - 38660 Adeje – Roque del Conde

## The property

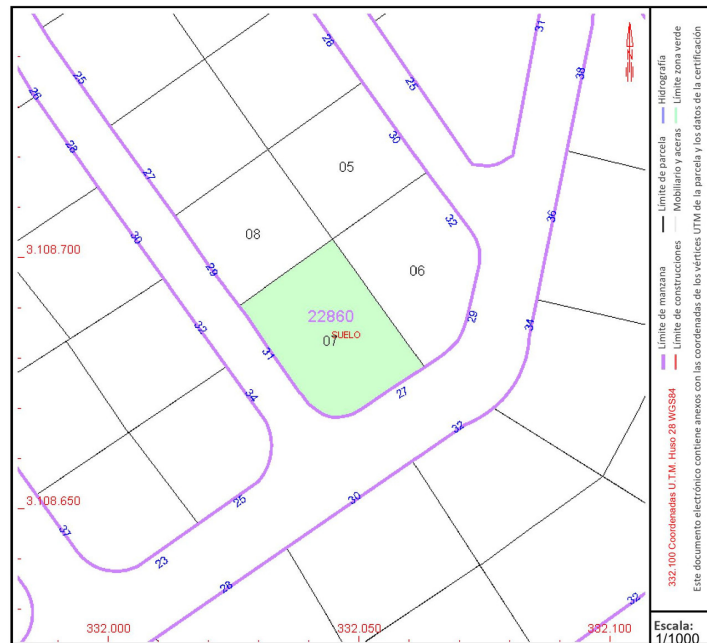

Property ID: ES243184889 - 38660 Adeje – Roque del Conde

## A first impression

Incredible investment opportunity in Roque del Conde! An exclusive corner plot with license and project is for sale in one of the most sought-after areas of the island. This plot of 700 square meters offers the possibility to build the home of your dreams in a privileged setting with panoramic views of the sea and mountains. With a prime location and unique architectural design, this corner plot is ideal for those seeking a luxury home in a tranquil and exclusive environment. The already approved license and project facilitate the construction process, saving time and effort. Don't miss the chance to acquire this unique plot in Roque del Conde and build the home you have always desired. Contact us today for more information and start making your dreams of living in paradise come true!



Property ID: ES243184889 - 38660 Adeje – Roque del Conde

## Details of amenities

- Corner plot of 700 m<sup>2</sup>
- Buildability: 262 m<sup>2</sup> + basement
- License + project
- Ready to build
- Sea views

Property ID: ES243184889 - 38660 Adeje – Roque del Conde

## All about the location

Roque del Conde is a requested and very popular location in the south of Tenerife, above the motorway from Costa Adeje. There are many properties that are used as holiday residences, but also many are used as main residences due to the good infrastructure. Roque del Conde belongs to the municipality of Adeje and offers, in addition to the well-known international school "Colegio Costa Adeje", many shops, restaurants, medical centers, butchers, bakers, etc. It is a quiet area, but only a stone's throw away from the tourist center of Costa Adeje, with beautiful beaches such as Playa Fañabe, Playa del Duque and a variety of tourist and shopping opportunities. Roque del Conde is ideal for those who want to live in a quiet and beautiful location with great views, but want to be very close to the tourist centers.

Property ID: ES243184889 - 38660 Adeje – Roque del Conde

## Other information

**RESPONSIBILITY:** The property information, documents, plans, etc. provided by us originate from the seller. We don't assume any liability for the correctness or completeness of the information.

All real estate offers are without obligation and subject to possible advertising errors.

### OUR SERVICE FOR YOU AS THE OWNER:

If you are planning to sell your property, it is important for you to know its market value. Let one of our real estate specialists professionally analyze the current value of your property free of charge and without obligation. Our international network enables us to bring sellers or landlords and interested parties together in the best possible way.

Property ID: ES243184889 - 38660 Adeje – Roque del Conde

## Contact partner

For further information, please contact your contact person:

Caroline Müller

---

Avda Chayofita 18, C.C. Parque Santiago 6, Local 24, E-38650 Los Cristianos (Arona)

Tel.: +34 922 105 023

E-Mail: [tenerife.south@von-poll.com](mailto:tenerife.south@von-poll.com)

*To the Disclaimer of von Poll Immobilien GmbH*

---

[www.von-poll.com](http://www.von-poll.com)